

TECHNICAL DATA SHEET

SYSTEXX Pure

Glassfibre wall covering featuring purist texture for walls and ceilings

Usage

SYSTEXX Pure glassfibre wall coverings are woven from glass yarns. They combine the outstanding technical properties of glassfibre wall coverings with the economical and ecological advantages of Aqua Technology. SYSTEXX Pure are ideal wall coverings for the interiors of commercial and private buildings. Individual designs can be created by using suitable creative techniques.

Aqua Technology: Applying the postage stamp principle to wall coverings. It consists of a uniform layer of adhesive pre-applied to the back of the wall covering in the factory and activated by water. The adhesive complies with the same requirements as conventional dispersion adhesives but with one particular advantage – since the wall covering is pre-pasted with just the right amount of adhesive, there is no danger of missing areas or applying too much.

Properties

SYSTEXX Pure wall coverings are classified flame-retardant according to DIN EN 13501-1:2010 and fulfill the requirements of class B-s1, d0. Thanks to their high quality, they meet Oeko-Tex Class 1. Due to their very low VOC emissions, these wall coverings achieve class A+ “d’émissions dans l’air intérieur”. Furthermore, they are permeable to water vapor, wall reinforcing and crack bridging, extremely abrasion and scrub resistant, impact and perforation resistant, resistant to disinfectants and cleaning agents (in combination with corresponding coating systems). They are non-toxic and suitable for allergy sufferers. SYSTEXX Pure wall coverings are quick and easy to hang thanks to Aqua Technology.

Technical data / roll dimensions

Product	SAP designation	approx.	approx.	Length in m	Pattern repeat
		Weight in g/m ²	Width in cm		
Pure Jute 004	GG 904 RW AQ 25m	325	100	25	→ 0 free match
Pure Big Stripes 006	GG 906 RW AQ 25m	320	100	25	→ 0 free match
Pure Small Stripes 025	GG 925 RW AQ 25m	320	100	25	→ 0 free match
Pure Dots 075	GG 975 RW AQ 25m	225	100	25	→ ← straight match 1,6
Pure Silk 060	GG 960 RW AQ 25m	225	100	25	→ 0 free match
Pure Structure 532	GG 133 RW AQ 50m	170	100	50	→ 0 free match
Pure Structure 603	GG 103 PG AQ 50m	195	100	50	→ 0 free match .
Pure Structure 604	GG 165 PG AQ 50m	195	100	50	→ 0 free match .
Pure Structure 608	GG 182 PG AQ 25m	250	100	25	→ 0 free match .
Pure Structure 629	GG 129 PG AQ 50m	165	100	50	→ 0 free match .
Pure Structure 633	GG 133 PG AQ 50m	185	100	50	→ 0 free match .
Pure Structure 635	GG 135 PG AQ 25m	215	100	25	→ 0 free match .
Pure Structure 639	GG 139 PG AQ 50m	170	100	50	→ 0 free match .
Pure Structure 650	GG 150 PG AQ 25m	200	100	25	→ 0 free match .

Substrate preparation

Substrates should be dry, clean, smooth and stable. Remove old wall coverings and unstable paints and finishes, sand down high-gloss paints to obtain a key and apply a suitable adhesion promoter. Sand down stable but rough/uneven substrates. Fill cracks/ holes with a levelling compound. The substrate must be prepared in such a way that the smallest unevenness are avoided, e.g. grains of sand, grain accumulations, etc. Processing marks may have a maximum width and height of 1 mm. If necessary, rework the surface over a large area with a smoothing plaster or in a smoothing step. Pretreat absorbent substrates with a suitable primer. Remove any mold growth and treat in accordance with the relevant regulations.

More details are to be found in the table "Substrate / Preparation".

Application

1. Using the Aqua Quick pasting machine

With Aqua technology, the wall coverings come with a dry adhesive layer which is applied evenly to the back of the wall coverings. The adhesive layer is activated by water. Therefore, pull the roll correctly through the water-filled Aqua Quick pasting machine according to the instructions and fold loosely without creasing. It takes approximately 1 minute to activate the integrated adhesive, or 2 to 3 minutes when applying to ceilings. For more information, please refer to the Aqua Quick manual. The drying time is 12 – 24 hours at normal room climate/temperature (18 °C, 60 %).

After activating the adhesive, process the wall coverings within a maximum of 20 minutes. When applying under extreme climatic conditions (high humidity, high temperatures), the duration can change significantly.

Make corrections within a maximum of 10 minutes after application to the surface. Depending on the surface and the ambient climate/temperature, the duration can change significantly.

Do not leave glassbased wall coverings immersed in water for more than 5 minutes as this may cause the adhesive to swell and liquefy. If the dwell time is longer, the optimum quantity and consistency of adhesive on the fabric can no longer be guaranteed.

Recommendation if a break is desired between cutting two lengths: Pull the length 50 cm shorter than required through the Aqua Quick pasting machine, then cut the length at the rear edge of the tub and pull the rest through the water. (Example: Pull the length to 2.00 m and cut off at the rear edge of the tub = total length 2.50 m).

2. Avoiding textural differences

Never paste the wall covering upside down or inside out. Some products have a handy mark on the back of the wall covering which serves as a guide. These marks are spaced at approximately 1 m intervals from one length to the next. **With straight match:** We weave an alignment guide into wall coverings with large-format repeated patterns to make it easier to align them: a yellow thread which is visible on both sides of the covering. When applying each consecutive length, simply make sure that the yellow thread is perfectly aligned with the yellow thread in the previous length. This ensures that the design is shown off to its full effect.

3. Butt-joining

Make sure that the edges butt up smoothly where one length joins another. Overlaps in the seam area must be avoided. Any adhesive left on the front of the fabric should be removed immediately with a damp clean cloth or sponge.

4. Pressing on and trimming

During application, use a (hard plastic) wallpaper spatula and press down firmly across the entire length, smoothing out any air bubbles. Carefully press overlapping fabric into the corners and cut sharp knife, using a wallpaper squeegee or cutting ruler as a guide, or just use wallpaper scissors.

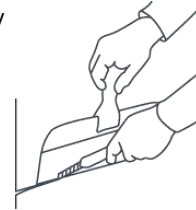

Processing on outside corners: Gently sand the fabric with wet sand paper, (> P 240), then wrap it around the corner and cut or use a corner bead.

5. Coating

The use of a high-quality dispersion paint is recommended. All gloss levels can be used, but note that matt colors can affect the textural image.

In case of pre-pigmented products: depending on the requirements for the surface appearance, one coat of white or lightly tinted matt or semi-matt coatings is usually sufficient. However, an intermediate coating may be necessary depending on the colour, degree of gloss, light situation, stress on the surface and the requirements for the surface appearance. At least two coats are required if the surface is required to be resistant to disinfectants or to be able to be decontaminated, or if the coating has a satin or glossy finish. A test coating is recommended in advance.

1st coat: Apply the coating evenly once the wall covering has completely dried. Follow the manufacturer's instructions.

2nd coat: Wait until the first coat is completely dry before applying the second coat.

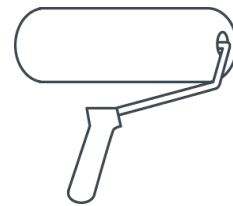

Recommended quantity: 290 - 450 g/m² for two coatings.

The quantity depends on the coating and substrate as well as the level of gloss required and whether the surface is subject to heavy use. Determine exact values by means of a test application on the object. For further information, please refer to the technical data sheets of all products used.

Paint application according to level of gloss

Desired top coat	Required base coat
Matt	Matt
Semi Gloss	Semi Gloss
- Matt-finish	- Matt-finish
- Satin-finish	- Satin-finish
Gloss	Gloss
- High gloss	- Satin
	- High gloss

Important notes

1. Storage

Store the rolls in a dry, clean place and, if possible, wrapped in foil and closed.

2. Handling

Do not apply with room and surface temperatures below +8 °C. Always check to make sure that the batch numbers are the same when applying the wall covering to adjacent areas (see information on outside of box or roll inlay). One drop = wall/ceiling height plus 5 – 10 cm. Trim off the excess neatly.

3. General information

- a) Despite strict quality controls, occasional production-related defects may occur. These are indicated at the edge of the product and compensated for by adding 0.5 m to the role length. Complaints made after more than 10 drops have been hung cannot be accepted.
- b) The use of glass fibers can irritate the upper layers of the skin, which can lead to irritation in sensitive people. Allergy-causing or even questionable substances are not used, which is confirmed by the Oeko-Text certification.
- c) Due to the manufacturing process of the weft, there are visually recognizable irregularities in the surface appearance of the fabrics. However, this deliberately created textile look is no reason for complaint.
- d) Since wallcovered surfaces depict a craftsmanship, completely homogeneous surfaces without small irregularities cannot be achieved. A visual perception of the wallcovering sheets and seams is product-specific and unavoidable. Also, "invisible" seams are not feasible from all conceivable angles. The assessment after application has to be carried out under customary conditions, in particular in daylight and normal ceiling/room lighting perpendicular to the surface while maintaining a normal viewing distance and viewing angle. For the assessment, artificial lighting to make minor irregularities visible are just as inadmissible as the evaluation in grazing light conditions that only occur at certain times of the day or the use of aids such as magnifying glasses.
- e) If light effects (e.g. grazing light) might influence the appearance of the finished surface, undesirable effects (e.g. changing shades on the surface) should be largely avoided. They cannot be completely ruled out, as light influences vary a lot and cannot be clearly detected and evaluated (e.g. in natural light). In principle, the lighting conditions, as they are intended for later use, must be known and should already be present at the time of the application. Before application, an assessment of possible undesirable effects should be made. In addition, the limits of craftsmanship on the construction site must be taken into account. Wallcovered surfaces which appear absolutely flat and shadow-free even under the influence of grazing light are not executable.
- f) This information sheet does not claim to address every problem that may occur in practice. Therefore no obligation or liability may be derived from it. Users are obliged to use their professional judgment to assess the application based on the product's suitability and the substrate. Please comply with the relevant national building regulations. In case of doubt, please contact the technical advisory service at Vitrulan Textile Glass GmbH.

Substrate Preparation

Substrate	Preparation
Exposed concrete	<ol style="list-style-type: none"> 1. De-burr roughly 2. Fill holes and cracks sufficiently 3. Sand and prime
Poured concrete, filigree concrete	<ol style="list-style-type: none"> 1. Clean (abrade and smooth down) 2. Fill holes and cracks, smooth and level with a suitable filling material 3. Cover and smooth the entire surface 4. Sand and prime
Sanding plaster	<ol style="list-style-type: none"> 1. Sand down (remove loose sand) 2. Stabilize substrate with a suitable primer 3. Fill holes and cracks, smooth and level with a suitable filling material 4. Sand and prime
Course textured plaster	<ol style="list-style-type: none"> 1. De-burr roughly 2. Fill holes and cracks, smooth and level with a suitable filling material 3. Sand and prime
Very absorbent plaster (e.g. gypsum plaster)	<ol style="list-style-type: none"> 1. If necessary, skim the entire surface and smooth off 2. Sand and prime
Standard plaster	<ol style="list-style-type: none"> 1. Fill holes and cracks, smooth and level with a suitable filling material 2. Sand and prime
Lining paper, size or sealer	<ol style="list-style-type: none"> 1. Dampen the lining paper, size, or sealer to loosen it 2. Scrape it off 3. If necessary, skim the entire surface and smooth off 4. Sand and prime
Peelable / stripable wallpaper Scrap wallpaper (e.g. cellulose)	<ol style="list-style-type: none"> 1. Remove wallpaper entirely 2. Fill holes and cracks, smooth and level with a suitable filling material 3. Sand and prime
Peeling / Flaking paint coating	<ol style="list-style-type: none"> 1. Remove all loose flakes 2. If necessary, prime the surface 3. Fill holes and cracks, smooth and level with a suitable filling material 4. Sand and prime
Distemper coatings	<ol style="list-style-type: none"> 1. Remove completely by scraping/washing off 2. Prime with suitable keying primer
Glossy paint coatings	<ol style="list-style-type: none"> 1. Sand until there is a mat finish 2. If necessary, apply a keying primer
Glass fabric¹	<ol style="list-style-type: none"> 1. Clean (abrade and smooth down) 2. Smoothen and level out fabric structure with a suitable filling material (prevents the formation of stripes in the texture) 3. Sand and prime

¹ otherwise, an unclean structural image is created which becomes extremely disturbing after coating

Plasterboard panels	<ol style="list-style-type: none">1. Fill joints and screw holes until even surface in accordance with current plasterboard specifications2. Sand and prime
OSB panels, wood, Hardboard	<ol style="list-style-type: none">1. Apply a protective layer (to prevent carry-over of constituents)2. Sand3. Fill joints and screw holes with suitable filling material4. Fill and level whole surface with a suitable filling material5. Sand and prime
Ceramic tiles	<ol style="list-style-type: none">1. Clean and degrease the tiles2. Apply bonding agent (undercoat/primer for ceramic and glass)3. Fill and level whole surface with a suitable filling material4. Sand and prime
Rusty steel surfaces	<ol style="list-style-type: none">1. Remove rust as per DIN 55928 PST 2-3 or ST 2-32. Apply a suitable anti-corrosive primer3. Fill joints with suitable (2-K) filling material4. Sand and prime (rust protection)
Bleeding surfaces (e.g. waterstains)	<ol style="list-style-type: none">1. Insulate bleeding areas with a suitable primer2. Sand2. Fill holes and cracks, smooth and level with a suitable filling material3. Sand and prime
Nicotine and soot deposits	Treat with an insulating protective layer